

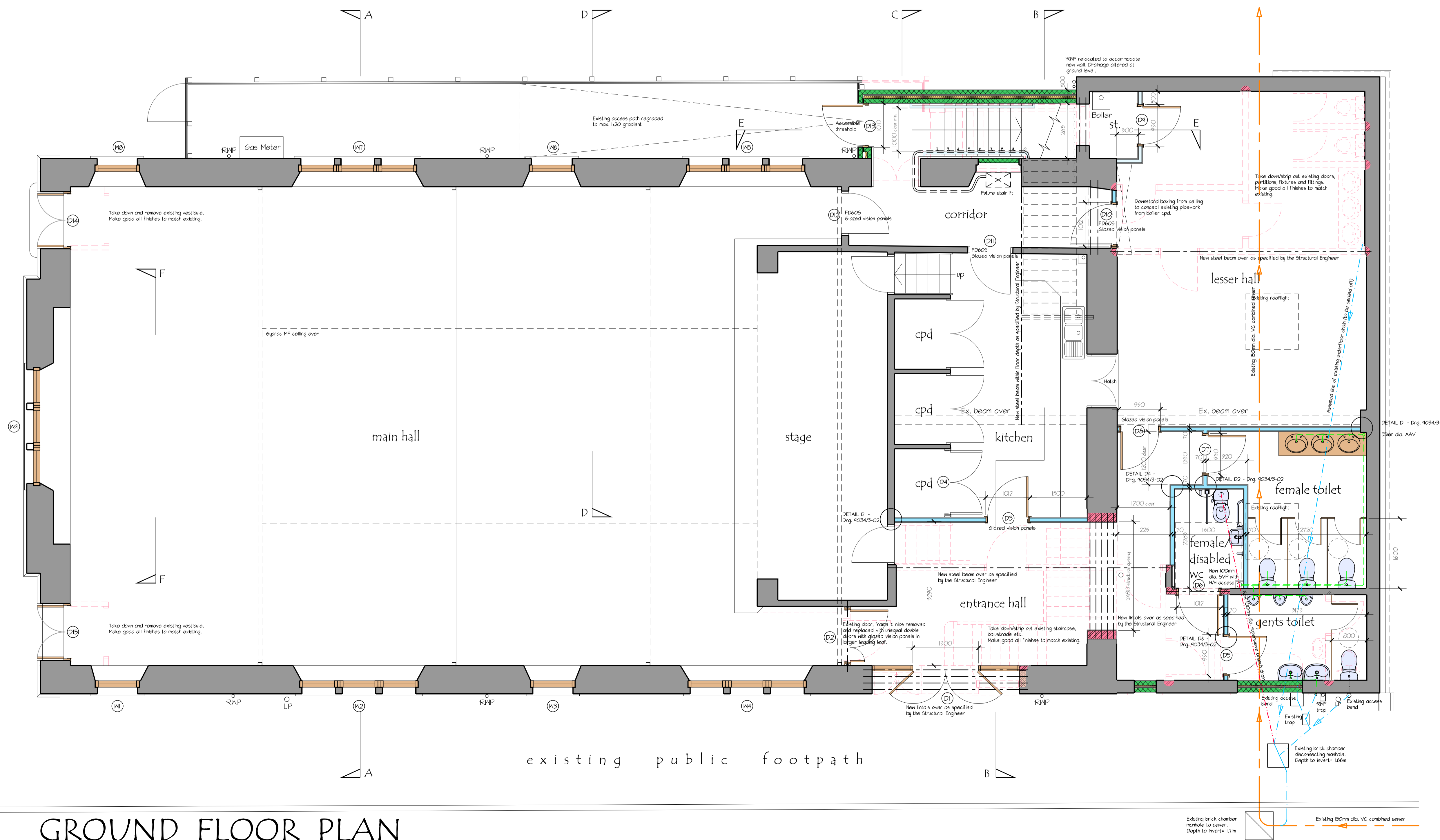

SOUTH WEST ELEVATION



NORTH EAST ELEVATION



GROUND FLOOR PLAN

Revisions:
 A Door and window references added. 4/10/2013 WRB
 B Detail references added. 10/10/2013 WRB
 C Gyproc ceiling noted in hall. 15/10/13 BG

camerons
 1 Wilderhaugh
 Gairnholm
 TD1 1QJ
 Tel 01896 753077
 Fax 01896 756046 email
 gairn@camerons.ltd.uk
 www.camerons.ltd.uk
 Also at:
 Timberbush House
 16 Timberbush, Leith
 Edinburgh, EH6 6QH
 Tel: 0131 553 7959
 Fax: 0131 553 7984
 edin@camerons.ltd.uk

client: St. Boswells Village Hall Committee
 project: Proposed Alterations & Improvements
 St. Boswells Village Hall
 Scottish Borders
 title: Ground Floor Plan and Elevations
 as Proposed
 scale: 1:50 & 1:100 @ A1
 date: 08 August 2013
 drawn: WRB
 file: q:\a2d\9034 - st boswells village hall\9034 proposals.dwg
 number: 9034/1-01 rev: C

architecture
 design
 development